

Cypress - 3 bed detached

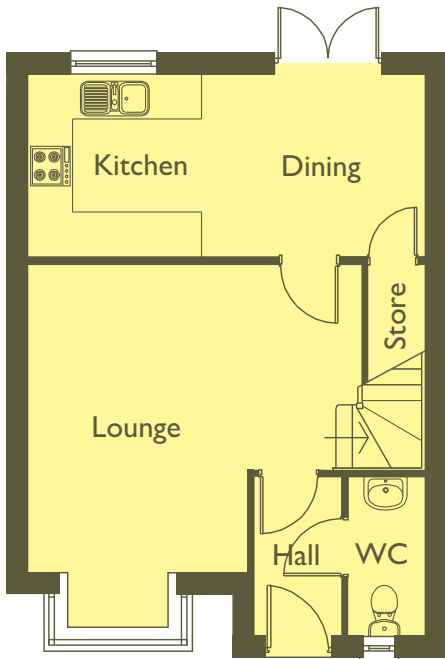

Ground Floor

Lounge	4600 x 4760	(15'1" x 15'7")
Kitchen/Dining	5465 x 2500	(17'10" x 8'2")
WC	2150 x 1070	(7'0" x 3'6")

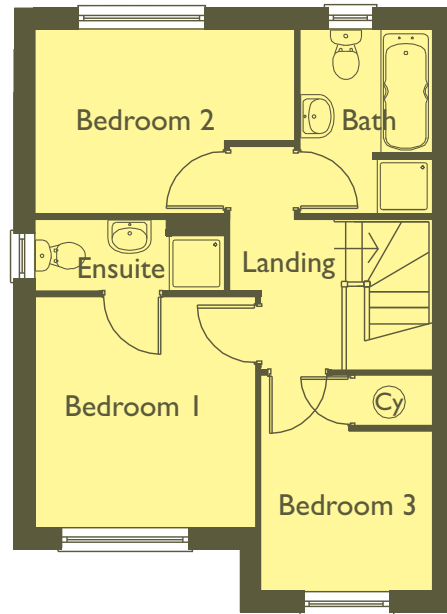

First Floor

Bedroom 1	3165 x 3055	(10'4" x 10'0")
Ensuite	2600 x 950	(8'6" x 3'1")
Bedroom 2	2550 x 3560 max	(8'4" x 11'8")
Bedroom 3	2320 x 3020 max	(7'7" x 9'11")
Bathroom	2550 x 1800	(8'4" x 5'11")